

LTECH



LED Touch Switch Panel - K1

Datasheet

www.ltech-led.eu | ©2019 | Ltech Europe | All Rights Reserved.

Technical Specs

Electronics

Input voltage	90 ~ 264V AC
Power consumption	200W
Power Supply	Internal
LED outputs	1

Control Characteristics

Dimming Protocol	Manual
------------------	--------

Wiring Specifications

Wire type	2,5mm ²
Wire Strip Length	5mm

Environmental

Ingress protection	IP44
Operating temperature	-30 ~ 55 °C

Input Characteristics

Input Frequency	50Hz
-----------------	------

Technical Drawings

4. Product Size:

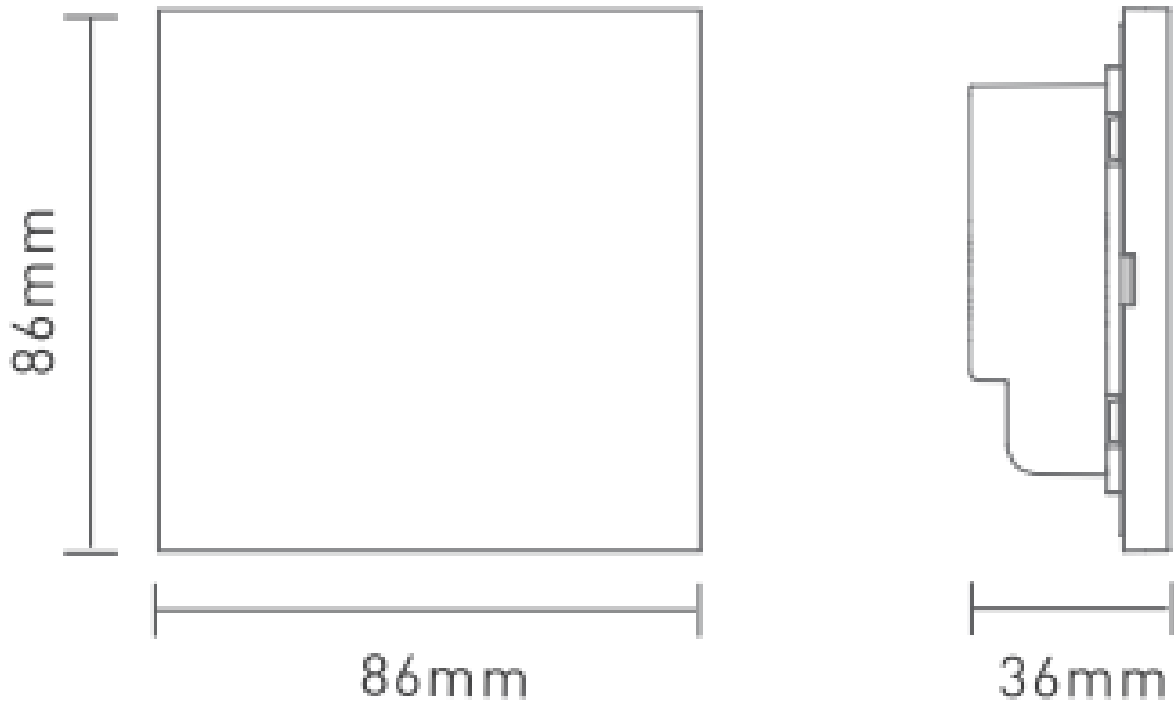

Wiring Diagrams

5. Wiring Diagram

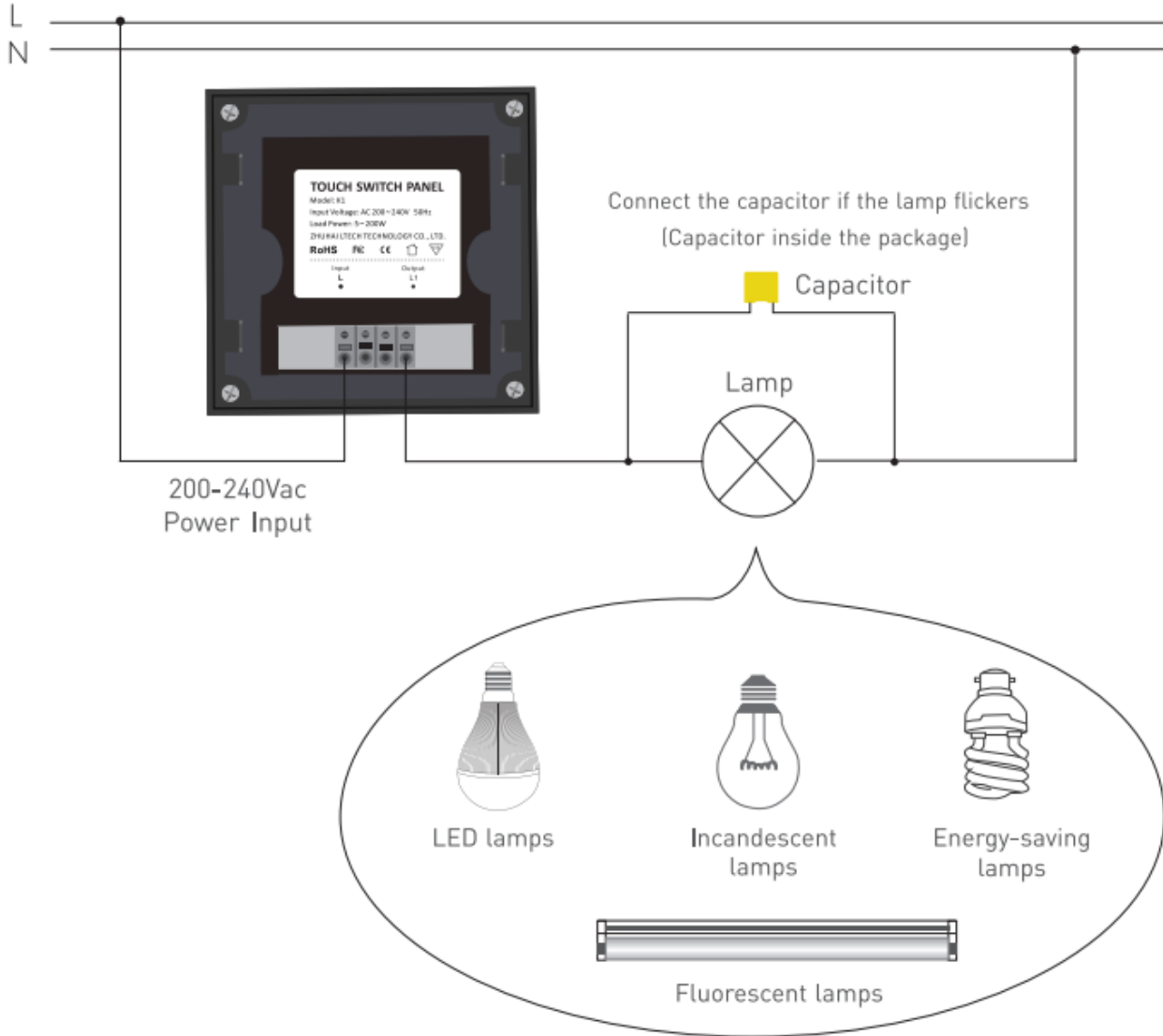

Order information

Code	Description
22581	LED Touch Switch Panel - K1